

Quick

Corporation
of America

STANDARD
QUICK

250

620 TERMINAL WAY • P. O. BOX 938 • COSTA MESA, CALIFORNIA 92627 • (714) 642-1163

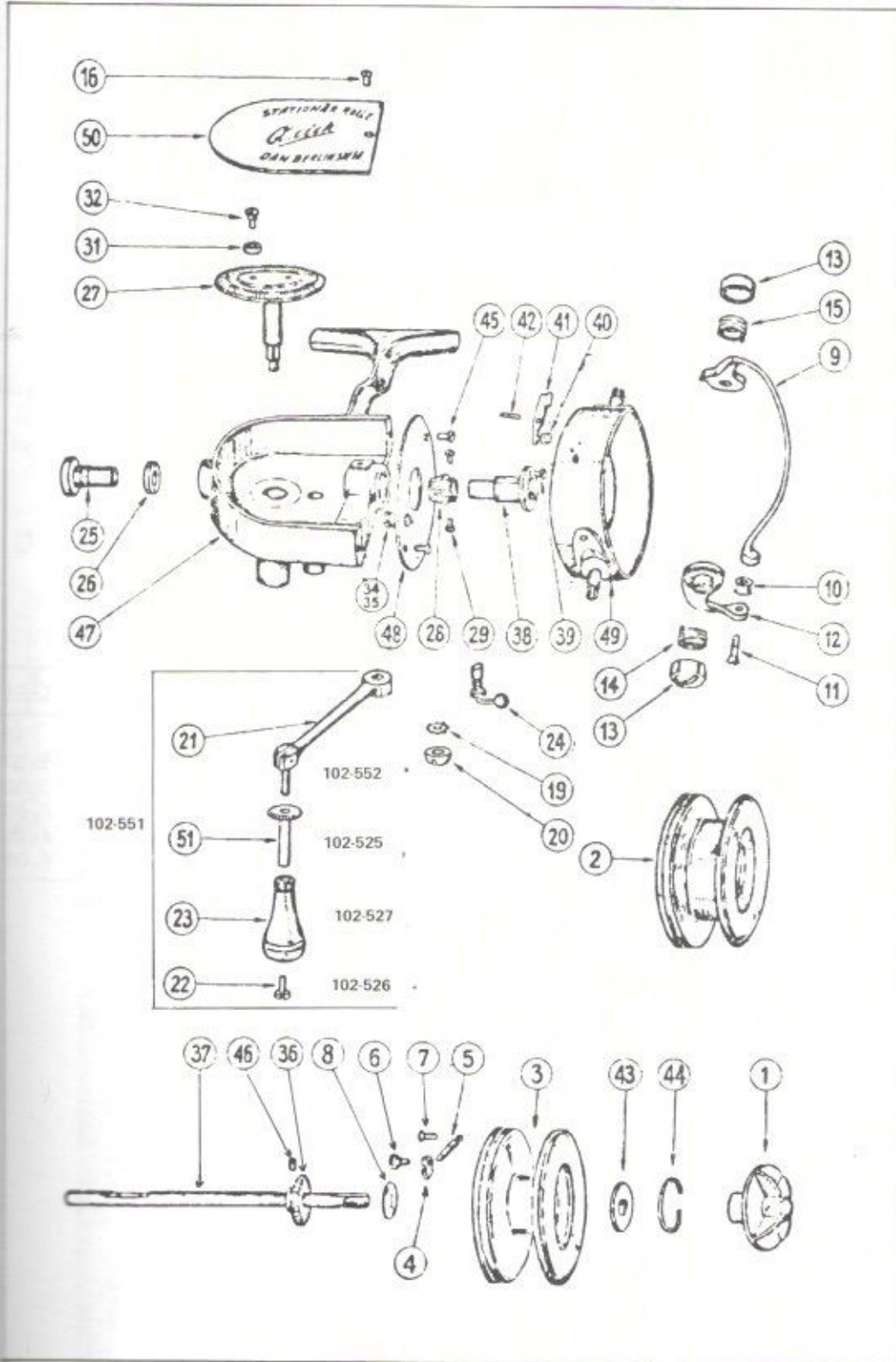

PART NO.	DESCRIPTION	PRICE
250/1	Brake nut	1.75
250/5	Spring	.25
250/8	Washer	.25
250/11	Screw	.45
250/12	Angle lever	1.65
250/13	Bail spring cover	.70
250/14	Bail spring	.30
250/15	Bail spring	.30
250/16	Screw	.25
250/19	Toothed washer	.25
250/20	N/A-use 102-553 nut	.60
250/21	N/A-use 102-552 crank arm	3.45
250/22	N/A-use 102-526 screw	.30
250/24	Anti reverse mechanism	1.95
250/25	Plug screw	1.55
250/26	Round nut	.70
250/27	Drive gear	3.70
250/28	Pinion gear	1.60
250/29	Screw	.25
250/31	Bushing	.50
250/32	Bushing screw	.30
250/34	Hexagon nut	.35
250/35	Bail trip	.75
250/36	Pin	.80
250/38	Bushing	2.30
250/41	Trip lever	.55
250/42	Pin	.25
250/48	Line measurement gauge	1.55
250/49	Rotating head	6.20
250/50	Side plate cover	1.20
102/551	Complete handle	4.85